

Series CH□KG

ø20, ø25
ø32, ø40
ø50, ø63
ø80, ø100

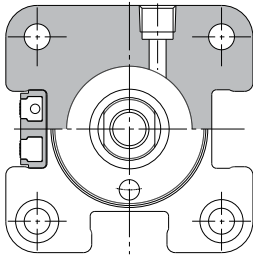

Construction



ø32 to ø100

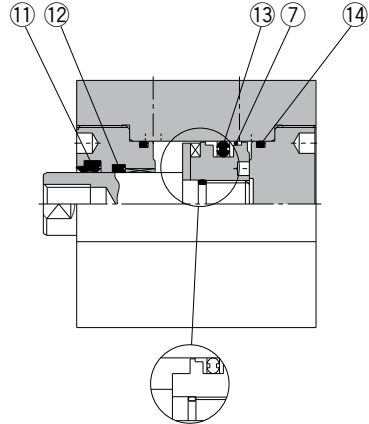

Without auto switch

* The numbers are the same as the "Construction" of the Best Pneumatics No.8 Series CH□KG.

*[BLUE](#) links will lead to purchase pages.

Seal Kit List

No.	Description	Material	Note
⑦	Back-up ring	Resin	
⑪	Scraper	NBR	With back-up ring
⑫	Rod seal		
⑬	Piston seal		
⑭	Tube gasket		

Replacement Parts: Seal Kit

Bore size (mm)	Seal kit no.	Content
20	CHKG20-PS	Set of left nos. ⑦, ⑪, ⑫, ⑬, ⑭
25	CHKG25-PS	
32	CHKG32-PS	
40	CHKG40-PS	
50	CHKG50-PS	
63	CHKG63-PS	
80	CHKG80-PS	
100	CHKG100-PS	

* Seal kit consists of items ⑦, ⑪, ⑫, ⑬ and ⑭ and can be ordered by using the seal kit number for each bore size.

* Special tools are necessary for disassembly. Contact SMC for recommended tool designs and dimensions. Furthermore, ø80 and ø100 are tightened with a large tightening torque, so disassembly will be difficult. Contact SMC if disassembly is required.