

# Rotary Clamp Cylinder/Double Guide Type

# Series MK2T

ø20, ø25, ø32  
ø40, ø50, ø63



## Construction

MK2T□20 to 63

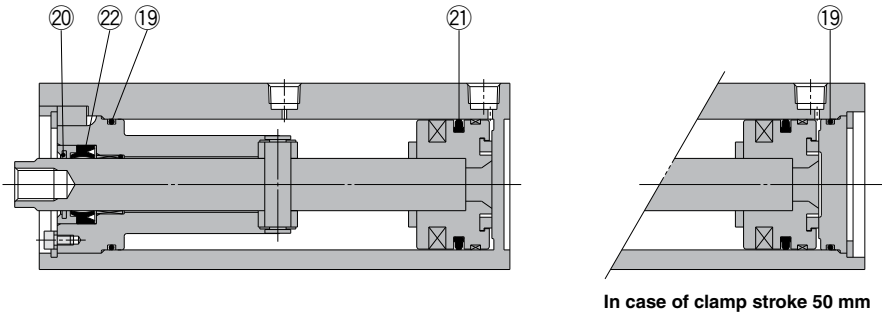

\* The numbers are the same as the "Construction" of the Best Pneumatics No.3 Series MK2T.

\*[BLUE](#) links will lead to purchase pages.

### Seal Kit List

No.	Description	Material	Note
19	Gasket	NBR	
20	Coil scraper	Bronze	
21	Piston seal	NBR	
22	Rod seal	NBR	

### Replacement Parts: Seal Kit

Bore size (mm)	Kit no.	Content
20	<a href="#">MK2T20-PS</a>	Set of left nos. 19, 20, 21, 22
25	<a href="#">MK2T25-PS</a>	
32	<a href="#">MK2T32-PS</a>	
40	<a href="#">MK2T40-PS</a>	
50	<a href="#">MK2T50-PS</a>	
63	<a href="#">MK2T63-PS</a>	

\* Seal kit includes 19, 20, 21, 22. Order the seal kit, based on each bore size.